



The Day 1 ALX

User Guide



www.yourkoalaa.com

Let Your Koalaa Journey Begin...

It's so great to meet you and we at Koalaa can't wait for you to use your Day 1 ALX. This booklet has all you need to know to get started but get in touch with your limb buddy any time if you have any questions on **hi@yourkoalaa.com**



Say Hello To Your Day 1 ALX!

The Day 1 ALX is the first of its kind: a soft prosthetic that can be used by amputees just a few hours after surgery.

What's included in your package?



ALX Day 1 Sleeve & Dock

The backbone of your Day 1 ALX is the blank sleeve



ALX Day 1 Cover

The Day 1 ALX is secured in place with a soft fabric cover

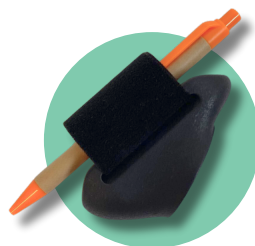

ALX Magnetic Janet

A multi-functional tool that holds a wide range of items



ALX Adaptor

Turn your dock into a magnetic connection

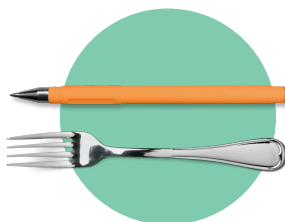

Fork & Pen

Test out the Janet tool straight away with these accessories

Taking Care Of Your Day 1 ALX

Safety



Comfort

Ensure the sleeve is comfortable and not too tight on your arm. If the ALX causes marking on your skin that does not go away after 20 minutes then the sleeve is too tight and should be loosened.



Dock Position

Ensure the sleeve is in the correct position with the tool release button facing upwards.



Take Care

Keep all digits clear of the dock when attaching tools to the sleeve.

Maintenance And Cleaning



Cleaning

Regularly clean your tools by wiping any excess dirt with a damp cloth.



Machine Wash

Wash your ALX blank and cover by removing the tool and then popping it in with your regular wash at 30 degrees.

Top tip! Put sleeve into a bag or pillowcase to protect the other items in your machine.



Store In A Cool Dry Place

To keep your sleeve and tools lasting longer, store in a cool dry place.



User Guide

How to use your Day 1 ALX

How to wear The Day 1 ALX

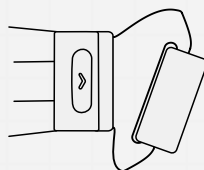
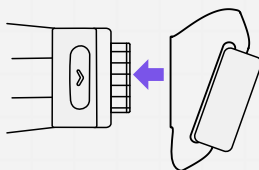
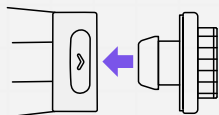
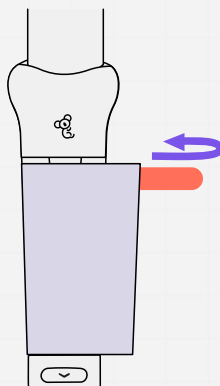
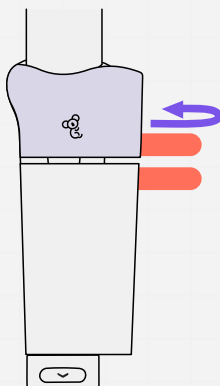
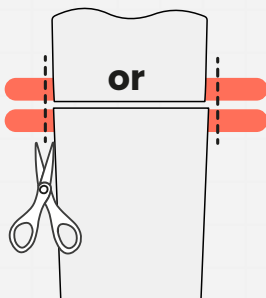
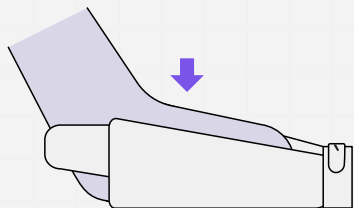

> **0.5kg**



How to use your **Magnetic Janet & Adaptor**

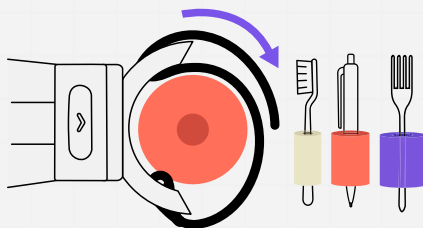
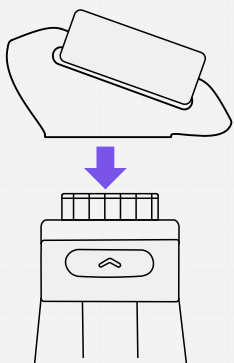
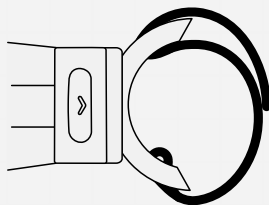
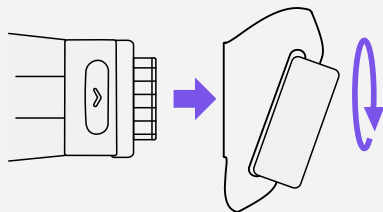
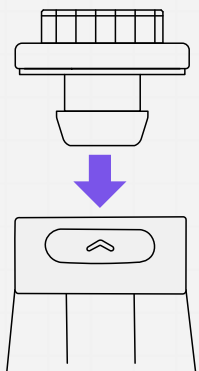

> **0.5kg**



Our Products

Find out about the Paww, ALX & Joeyy

Meet The ALX

For Below Elbow

The ALX is the perfect fit for **below elbow and partial wrists**. Made up of a flexible sleeve with a soft fabric cover to hold it in place, the ALX is unlike any other prosthetic on the market. Whereas most rigid prosthetics rely on friction, suction or a pin lock mechanism, the ALX grips more like sportswear; strong, soft and snug.

The ALX sleeve is compatible with a wide range of detachable tools, opening the door to countless activities.



ALX Cover



ALX Socket

Sarah
ALX Tool

Lockable
Dock

The ALX Tools



Janet
ALX



Sarah
ALX



Kitty
ALX



Amy
Paww



Rushton
ALX



Grace
ALX



Nicole Pro
ALX



Nicole
ALX



Joanie
Tool



ALX & Paww Covers

The ALX and Paww sleeves are secured in place with a soft fabric cover. Stand out or blend in, the choice is yours with our awesome range of covers designed in house by our very own Lauren and Esmé.



**Dinourmous
Dinos**



**Rare
Rainbow**



**Snazzy
Superhero**

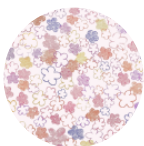

**Flower
Power**



**Safari
Adventure**



**Wildflower
Meadow**



Custom Covers

Wear a sleeve as unique as you are with Koalaa's bespoke cover design service.

Our design team will create a sleeve just right for you and you'll walk away with a completely unique cover for your Koalaa sleeve.

To get yours get in touch at
hi@yourkoalaa.com

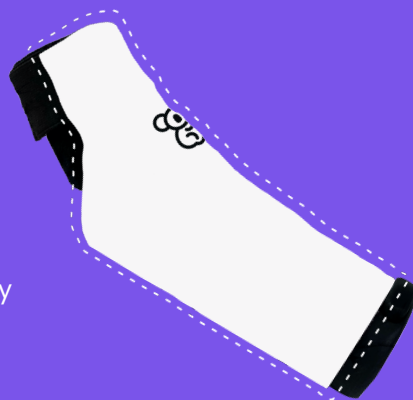

Cosmetic Hand & Covers

For times when you would like something more discreet, our cosmetic hands and covers can be matched to any skin tone. The realistic fingers on the hand can also be moved into different positions. Lastly, your long-sleeve clothing can be pulled down over your Koalaa prosthetic, leaving just in hand on show.



**Find the colour to
match your skin**

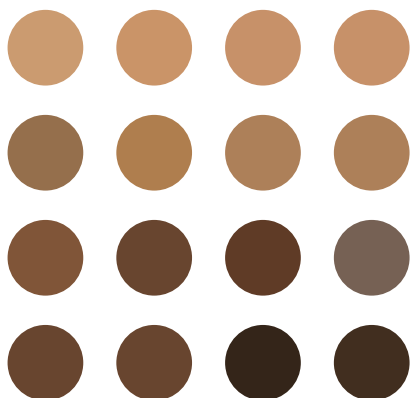

Designed by you, made by us!



Nicole

"The ALX has opened up so many more opportunities for me at home and at the gym".

Aurora

"I love using my prosthetic to ride my bike, cut up food, for painting pictures and my nails. Holding the polish in the Koalaa tool and using my right hand to paint is so amazing!"



Join The Koalaa Community

Our users have become an incredible community who love to share their experiences with Koalaa and each other.

@koalaacommunity



Send in your snaps!

We love to see how our users are getting on and what they're up to with their Koalaa sleeves. Send your stories, videos and photos to your limb buddy or email them to us at hi@yourkoalaa.com



Joanie

"I was really happy when Koalaa told me they were going to make a tool to help me throw the ball and that it was going to be called after me."



Private Facebook Group

Join our private Facebook group and we'll accept your invitation as soon as possible. This is a closely monitored group so you can share all your photos with others safely.

Contact A Limb Buddy

Sometimes you want to ask a simple question, other times you just want to chat. At Koalaa there's no need for formal appointments and long waits, with our limb buddies available throughout the week you can get in touch any time.



hi@yourkoalaa.com



+44 (0) 7482 165 098



@koalaacommunity



Want to return or replace your ALX?

If there are any issues with your ALX sleeve or tools contact your limb buddy directly or at **hi@yourkoalaa.com** and we'll do our best to solve any issues, replace the product or offer a full refund.



Scan Me!

Scan the QR code to find our Koalaa Hub, here you'll find a digital version of all our Koalaa sleeve and user guides for you to use on the go!



The ALX has been awarded the following CE mark:
Medical Device Regulation MDR, EU 2017/745 Regulation

This means it conforms with health, safety and environmental standards for products sold within the European Economics Area.